

TRIMO



Remote Site Camp Medco, Doha, Qatar



Remote Site Camp, Al Wasita, UAE

Remote Site Camp, Libya

Efficient, Innovative, Sustainable TRIMO MODULAR SPACE SOLUTIONS

Industrial

Sometimes industry requires factories or operations to be located in remote locations and this can mean sending the workforce to some of the harshest environments for extended periods. Typically this may be mining, oil exploration, telecommunications and energy installations, which may need to be located in hot deserts to northern cooler climates and it is here where Trimo's complete camp solutions excel. Safe, comfortable and inviting places to live and work, they offer the ultimate solution. Trimo also offers a wide range of modular units that have been optimised for use as telecom installations, industrial applications and other bespoke applications and its engineers work with the best materials to adapt to any specific customers requirements.

Trimo

- One of the leading providers of modular solutions.
- 25 years of experience.
- Almost 100,000 units manufactured and supplied in more than 40 countries worldwide.
- Highly experienced engineering, production and sales teams.
- Holding ISO 9001, ISO 14001, BS OHSAS 18001 and CE certificates.

References

- Remote Site Camp Medco, Doha, Qatar
- Remote Site Camp, Al Wasita, UAE
- Remote Site Camp, Hammar and Rafidiya, Iraq
- Oil Rig Field Camp Support, Hassi Messaoud, Algeria
- Remote Site Camp, Libya
- Remote Site Camp I, Al Raha Beach, UAE
- Remote Site Camp, Al Ain, UAE
- Waste Treatment Center, Ptuj, Puconci, Račje selo, Slovenia
- Waste Treatment Center, Krk, Croatia
- Accommodation Camp, Iceland
- Accommodation Camp, Majnoon oil Field, Iraq
- Accommodation Camp, Muscat, Oman
- Remote Site Camp, Sendje Village, Equatorial Guinea
- Remote Site Camp and Cold Storage Room, Algeria
- Telecommunication Stations, Akhaltsikhe and Zestafoni, Georgia
- Telecommunication Stations, Panama City, Panama
- Telecommunication Stations Mobitel, SŽ, Slovenia
- DMS Gas Station, Denmark
- Japanese Navy Camp, Djibouti



Oil Rig Field Camp Support, Hassi Messaoud, Algeria



Waste Treatment Center, Krk, Croatia

Modular Unit

1. Reinforced steel framework

Highest quality steel can be additionally coated and galvanized for use in the toughest climatic conditions. Steel construction is designed for easy handling and linking and also includes rainwater draining within the corner pillars.

2. Easy to transport and re-locate

Can be transported assembled due to special integrated vertical and horizontal reinforcements.

3. Windows & Doors

Standard or non-standard windows made in EU with CE mark are available. Insulation of windows as high as $U=0.7 \text{ W/m}^2\text{K}$.

4. Long term economic benefits

Can be assembled and disassembled a minimum of 3 times and can therefore be used on many consecutive projects and over a long time period.

5. Tailor made solutions in accordance with customer needs

Façade Panels

6. Thermal and sound insulation

Using various Trimo FTV fireproof panels of 60 to 133 mm thickness, thermal conductivity values (U) as low as $0.30 \text{ W/m}^2\text{K}$ can be guaranteed as well as an R_w sound reduction of 32 dB.

7. High Density Rock Wool

$100\text{-}120 \text{ kg/m}^3$ assures vertical consistency and prevents heat bridges during the complete life span of the product.

8. Completely fire proof solution

Walls, floors and ceilings are made of "A1" class non-combustible materials, are completely recyclable and environmental friendly. EI Fire resistance class certified (EI30 - EI120).

9. Various profiles and custom colours

Various faced profiles are available to meet customers' demands and any colour from the RAL colour-chart.

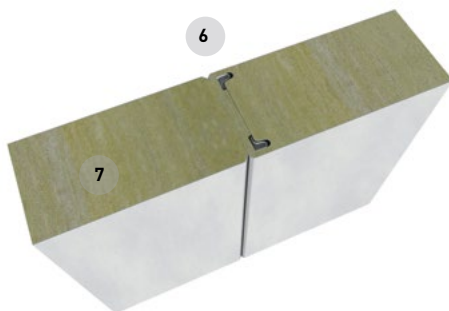
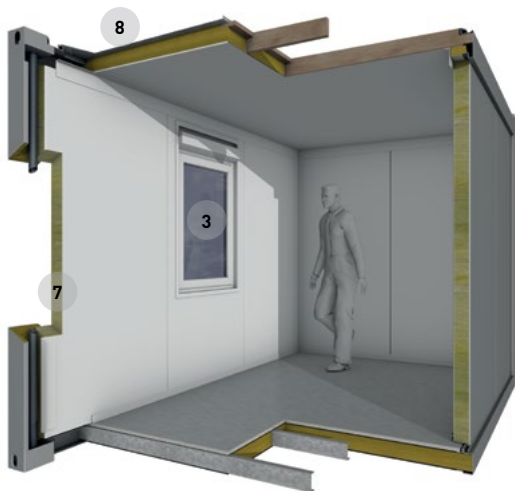

Complete sand, wind
and water tightness



TRIMO

TRIMO MSS, D. D.

PRIJATELJEVA CESTA 12,
8210 TREBNJE | SLOVENIA

T: +386 (0)7 34 83 500

E: TRIMO.MSS@TRIMO-GROUP.COM

WWW.TRIMO-MSS.COM